



Your App Guide

How to Create an App Login

- 1) Go to the App Store on your mobile device and search for “The Edge Fitness Club”. Download the app.
- 2) Make sure to opt into Location Services and Push Notifications when opening the app for the first time. This allows you to get the most recent club updates and location info!
- 3) Click "LOGIN/SIGN UP" on the home screen to get started.
- 4) Select “Create Account”
- 5) Choose your home club (must match the joining location in the club’s membership system)
- 6) Complete the Sign Up process by entering your:
 - 6a) Membership barcode number (the same one used for your membership keytag)
 - 6b) First & Last name
 - 6c) Email & Password to use for your app login.
 - 6d) Agree to Terms of Use and click “Submit” to gain app access

1) Login / Signup



2) Create an Account

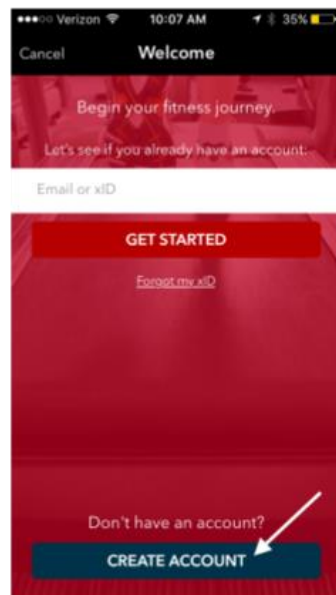

3) Select Home Club

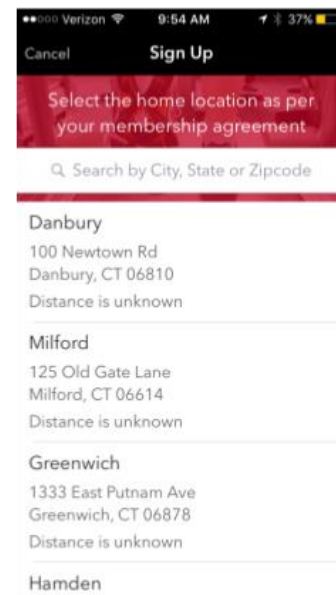

4) Complete Sign Up

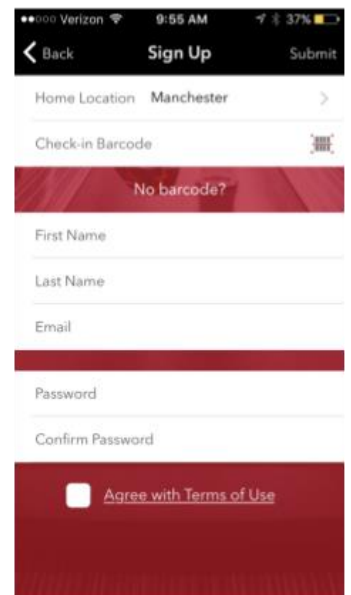

How to Enroll in Classes:

- 1) Select the “Find a Class” tile to access the class schedules
- 2) Scroll through a list of class types and times offered in your home location. Click “Enroll” to book the class of your choice.
- 3) You will be directed to a login page for the “MyiClub Online” portal hosted by ABC Financial to complete your class enrollment. Enter your login credentials if you have one, or click “Register Now” to create a new login.
- 4) You will be prompted to enter you membership Agreement Number and personal information. If you do not have your Agreement Number handy, you can request having it sent to your email.
- 5) At any time, you can also see and book classes for other Edge Fitness Clubs locations. Click the search icon at the bottom to see a locations list, and also choose your favorite clubs!

1) Click “Find a Class”

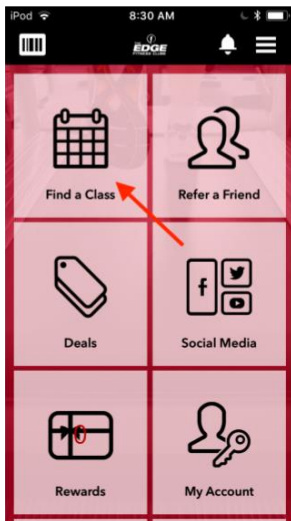

2) “Enroll” in a Class

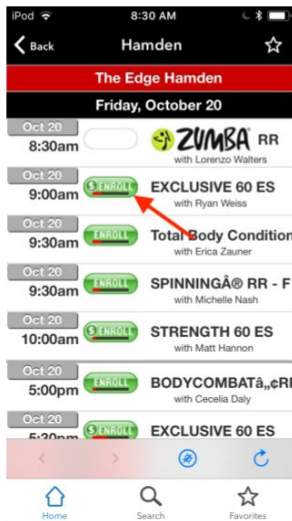

3) “Register” for an ABC MyiClub Online Login

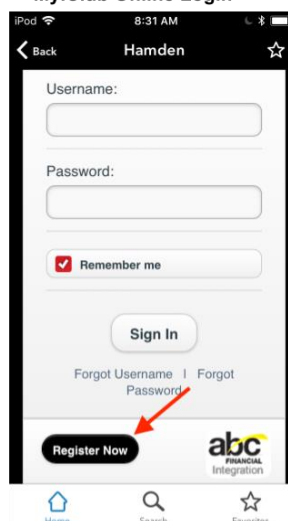

4) Enter or Request your Membership Agreement #

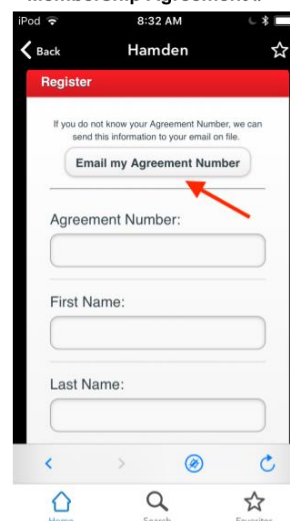

5) Search Classes by Location Choose your Favorite clubs

